

W1231-2 Pro Clima Truss Eave - Vented Soffit with Vent Baffle

Install pro clima **SOLITEX MENTO®** Roof Weather Resistive Barrier over rafters. Batten height can be increased up to 45mm in combination with larger eave vents in accordance with "strong ventilation" requirements to improve the purge rate of heat in summer.

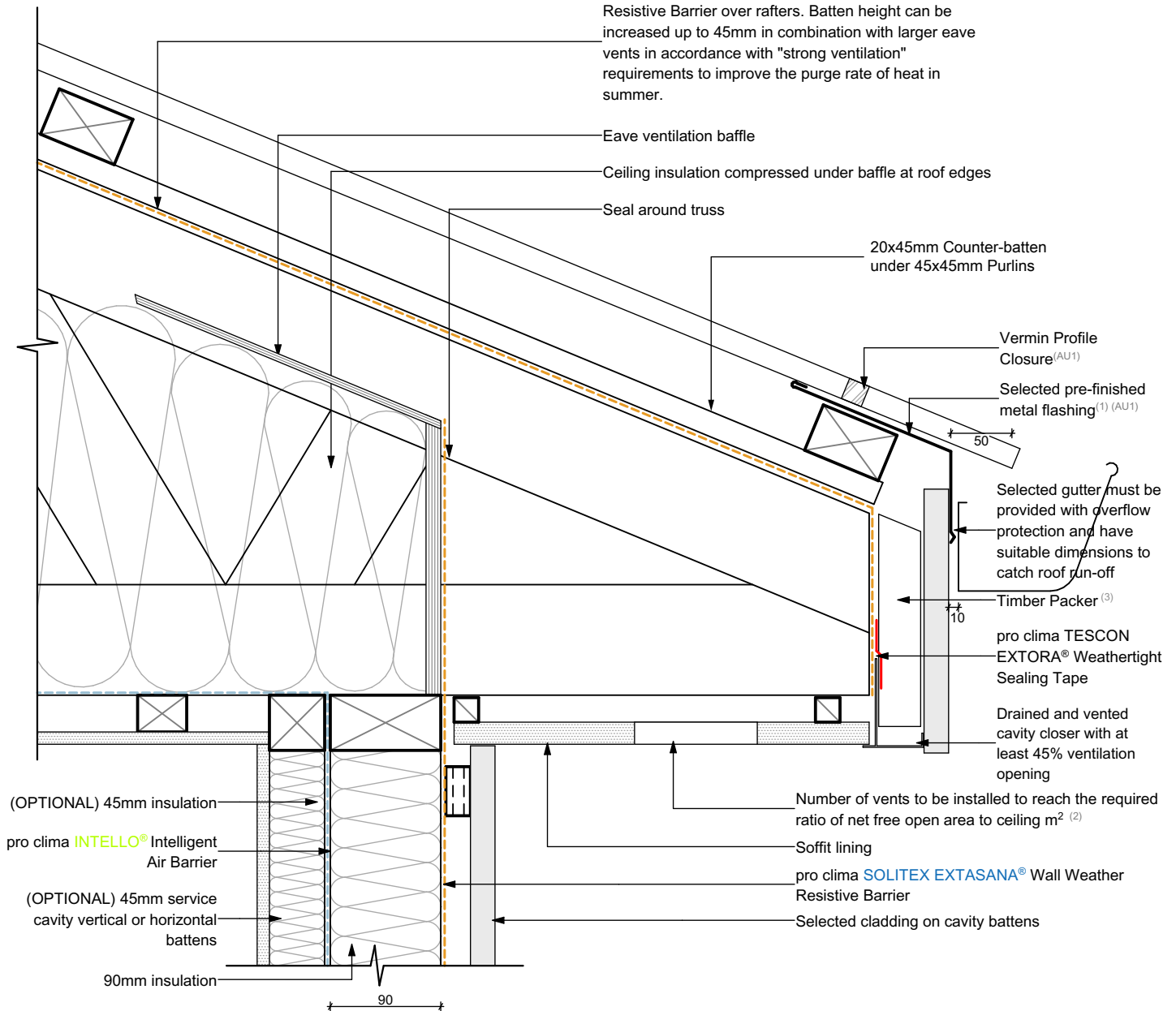

NOTES:

- Additional ventilation can be achieved to increase the purge rate of heat in summer by utilising a perforated flashing at eave.
- Recommended total amalgamated vent area should be equal to 1:300 ratio between the net free amalgamated opening area of the vents to the area of insulated ceiling. Vents should be evenly distributed around the roof perimeter. Outlet vents, such as ridge vents, must only be installed in conjunction with inlet vents. Inlet vents should be dimensioned slightly larger than the outlets to ensure all makeup air comes from outside and is not drawn from inside. 30% of the total unobstructed area required should be located not more than 900 mm below the ridge or highest point of the roof space, measured vertically, with the remaining required area provided by these eave vents.
- Normal Ventilation: Timber packer should be 45mm in combination with at least 45% open area cavity closer.
Strong Ventilation: Timber packer should be 90mm in combination with at least 45% open area cavity closer.
The depth of cavity can be reduced for cavity closers with higher open area ratios.

$$\text{Ventilation} = (\text{Packer}) \times (\text{Open Area Ratio})$$

Normal Ventilation $\geq 200\text{cm}^2/\text{m}$
Strong Ventilation $\geq 400\text{cm}^2/\text{m}$

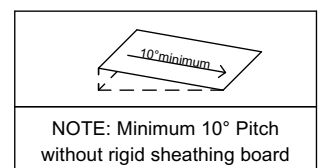

AUSTRALIA ONLY:

- Cavity Closer must meet AS 3959 requirements for bushfire protection up to BAL 40. This can be achieved by fitting an ember guard made of non-combustible material or a mesh or perforated sheet with ≤ 2 mm holes and made of corrosion resistant steel or bronze.

Title: Truss Eave - Vented Soffit with Vent Baffle



ID: W1231-2 Issued: 25/05/2020 Revision: D

© This drawing is the property of Pro Clima NZ Ltd &/or Pro Clima Australia Pty Ltd and must not be copied without permission. This drawing is a guideline only and subject to change without notice. Thermal and hygrothermal performance should match specific design, materials and climate requirements. These can be confirmed by hygrothermal analysis using software e.g. WUFI®. Structural, fire and acoustic engineering design and the incorporation of building services (plumbing and electrical) should be signed-off by a suitably qualified engineer to ensure compliance with all health and safety requirements.